



CUSTOM LINE NAVETTA 30















93ft | Custom Line | 2024

For Sale: €12,500,000

★ **STARSHIP YACHTS**

G/F, Unit 3, Aberdeen Marina Tower
8 Shum Wan Road, Aberdeen, Hong Kong
Tel: +852 2555-2805
STARSHIPYACHTS.COM
info@starshipyachts.com

Specification

 Interior design Filippo Salvetti	 Build Custom Line		
 Length Overall 28.43 m (93 ft 3 in)	 Beam 7.52m (24 ft 8 in)	 Draft 2.18m (7 ft 2 in)	 Displacement 182,000 kg
 Guests 20	 Cabins 5	 Crew Cabins 3	 Crew 5
		 Generator Hours 460/534	
 Maximum speed 14.5 knots	 Cruising speed 13 knots	 Engines X 2 MAN 1000 HP LE426 V8-1000	 Engine Hours 125

CUSTOM LINE



All particulars are believed correct but cannot be guaranteed

CUSTOM LINE



CUSTOM LINE



CUSTOM LINE



CUSTOM LINE



CUSTOM LINE



CUSTOM LINE



CUSTOM LINE



CUSTOM LINE



CUSTOM LINE



CUSTOM LINE



CUSTOM LINE



CUSTOM LINE



CUSTOM LINE



CUSTOM LINE



CUSTOM LINE



CUSTOM LINE



CUSTOM LINE

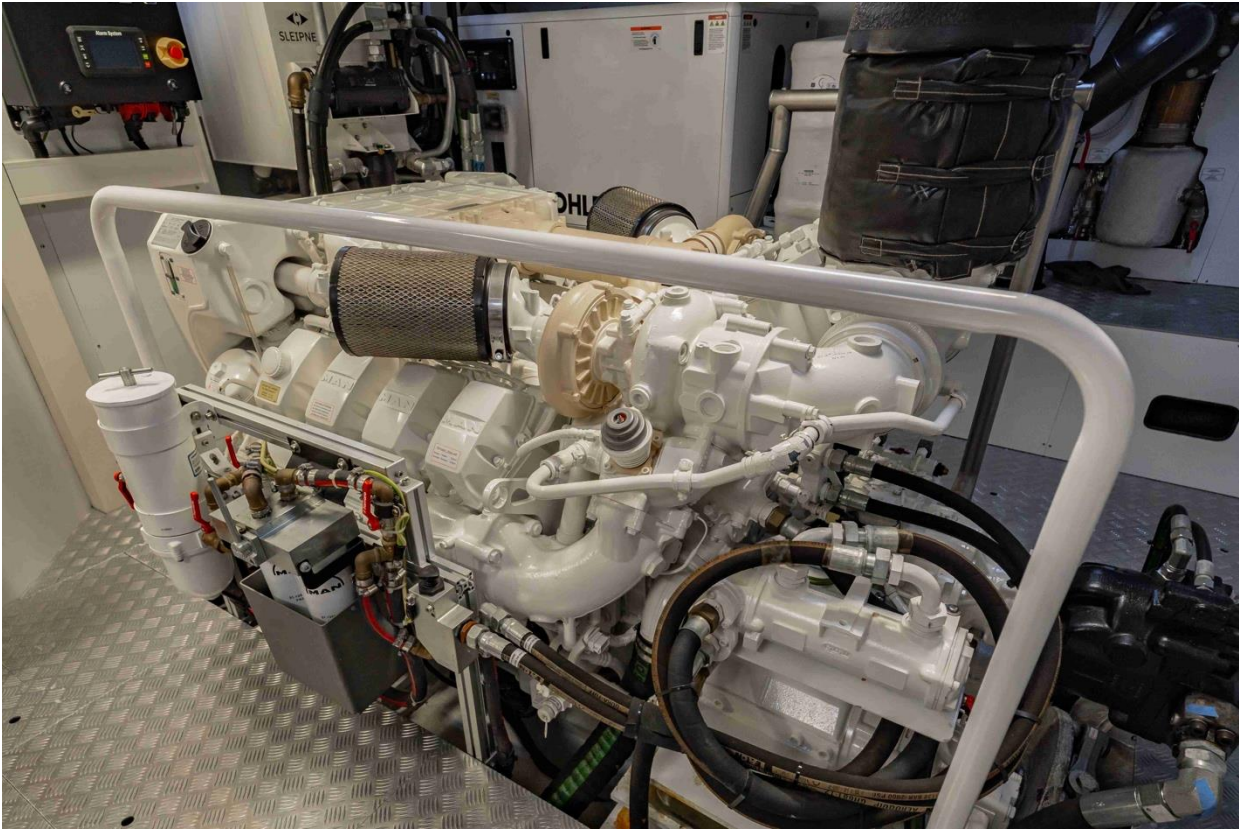

CUSTOM LINE

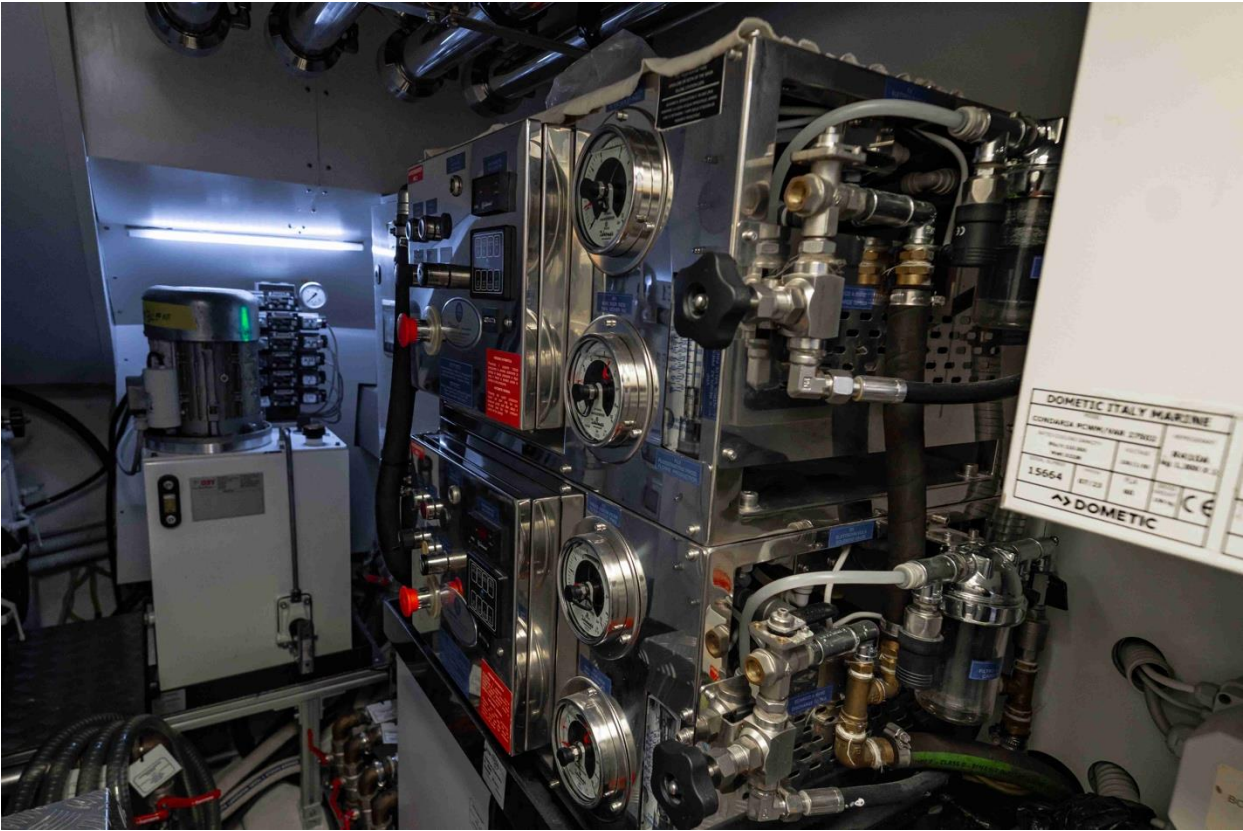

LAYOUT

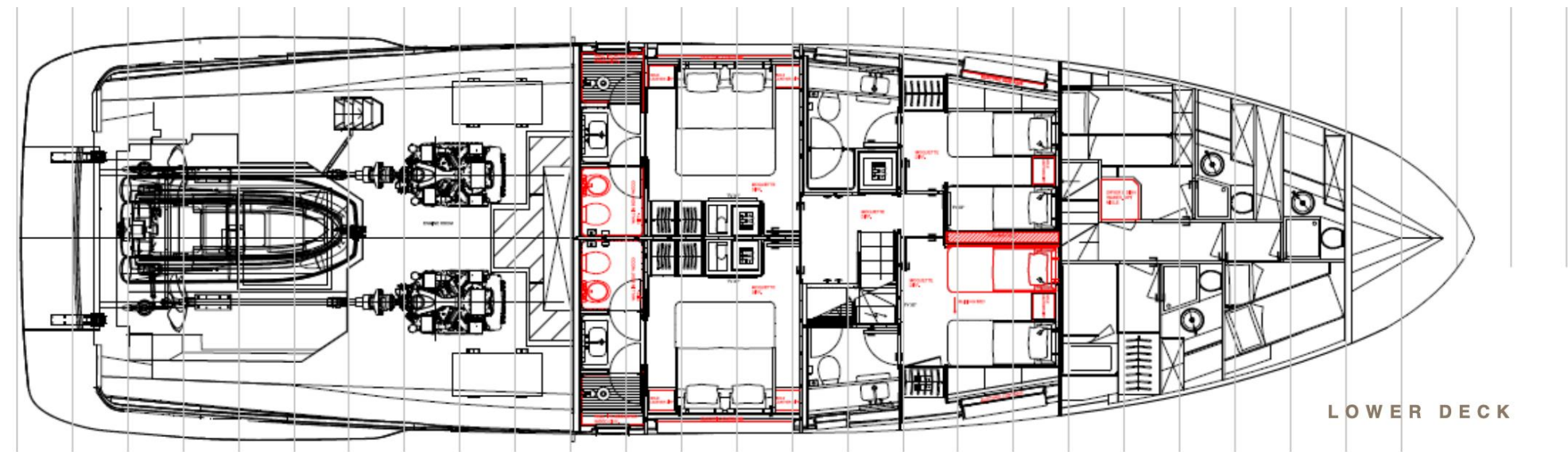
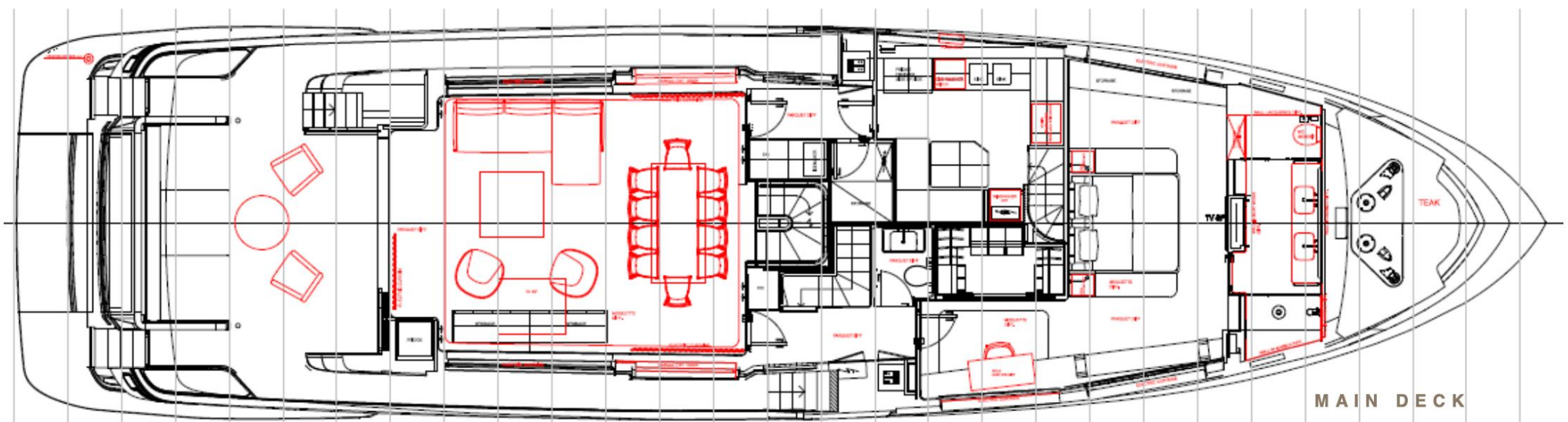

LAYOUT

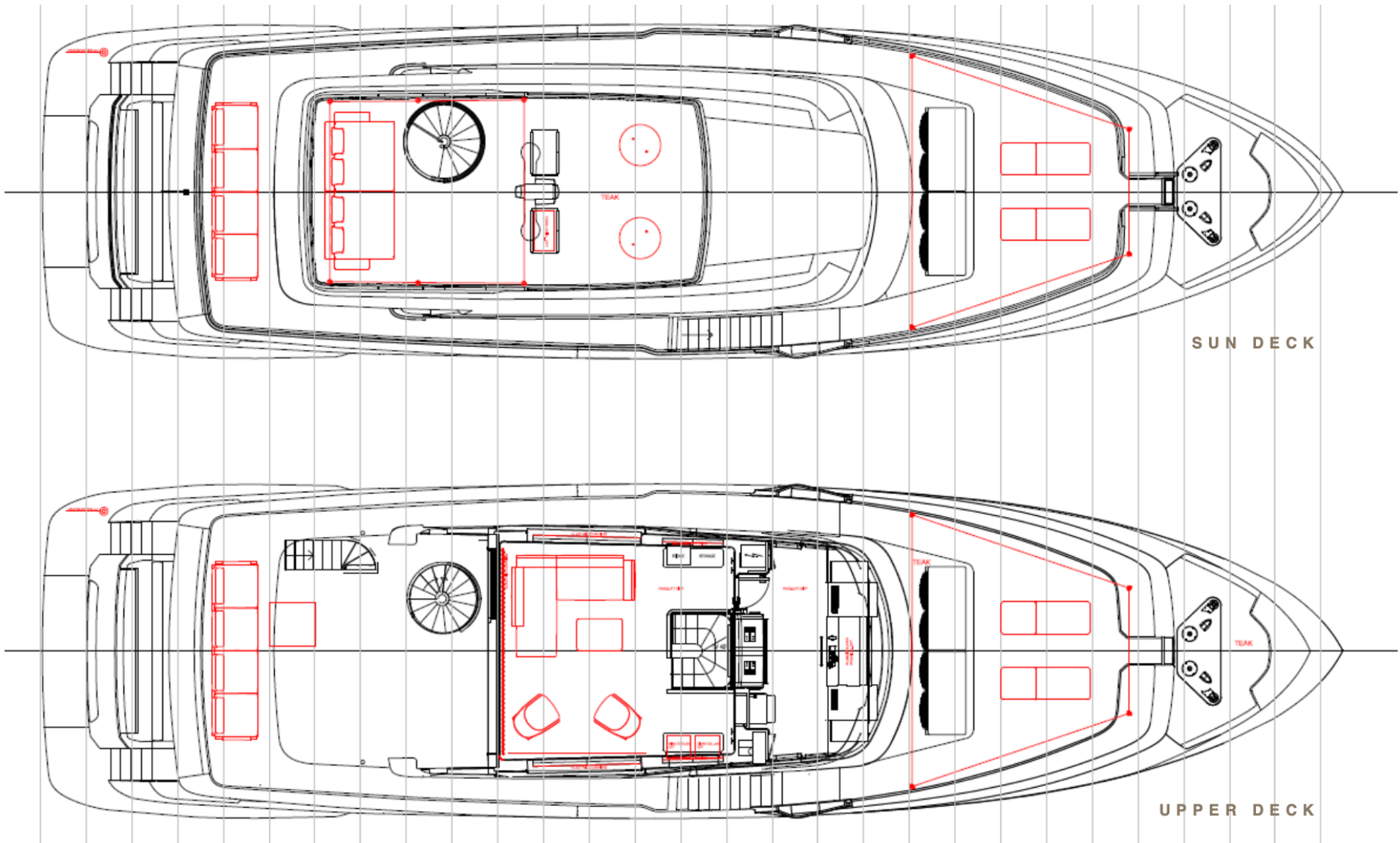

Accessories



"Miele" galley appliances diff
TEXAN GRILL ON SUN DECK DIFF.
LAVATRICE/ASCIUG.SEPAR.MIELE DIFF.DA STD
Automatic battery charger for generator
fuel filter Alfa Laval
MECHANICAL SEAL IDROSTOP
water softener
Watermaker Idr 250+250 l/h duplex diff.
bimini for dinette at bow (manual)
SD stern bimini top
Courtesy lights and dimmers for exteriors
shower (cold and hot water) on bathing platform
Light Underwater -each-
Floor teak covering with black caulking on sundeck and forward triangle area
Air extraction in the Lower Deck cabins' bathrooms
Salon curtains electrically-driven lifti
Decorative lighting strips
LIGHTNING ROD BENEATH THE BEDS
Dimmers for interiors lights
curtains: electrical raising for lower deck (4 cabins)
electrical curtains in Upper Deck
SALON MANUAL PORTSIDE DOOR LOUNGE
SALON MANUAL STARBOARD DOOR LOUNGE
pullman bed in the port guest cabin
BIG BED IN STARBOARD BOW GUESTS CAB
air conditioning super-tropical
WINDOW WITH PORTHOLE IN GALLEY

autoidentification system AIS receiver SIMRAD NAIS500
FLIR NIGHT VISION THERMAL CAMERA
Radar antenna HALO 6 diff. from Halo 3
stern thruster 30 HP
Super Premium Integrated Bridge -diff-
GYRO STABILIZER
A/V PACKAGE PREMIUM SOUND AREA B
TV 55" W/LIFT IN SALON DIFF DA STAND
Electro-hydraulic system hauling and launching jet ski in garage
TENDER WILLIAMS SPORTJET 435 with fixing

Miele wine cellar in Galley
Wine Cellar in UD Salon

Cigar Fridge in UD saloon
Top in leather bedside-table and furniture in master cabin
A/V PACKAGE PREMIUM SOUND EXTERNALS SONANCE
A/V PACKAGE PREMIUM SOUND AREA A
Sink top: Marble Arabesque Orobico Lucido + 2 sinks in fumè glass
Peplink Modem 5G
antenna empty dome for KVH TV8 for symmetry on roll-bar
antenna empty dome for TV8 for symmetry on roll-bar
WC Geberit in master bathroom
Extra furniture in master bathroom
TV 55" in salon UD diff.
FRAME TV SAMSUNG MASTER CABIN
UBIQUITY WIFI 6 SUPER PREMIUM WIFI UPG
Frame TV Samsung in lower deck cabins upgrade



G/F Unit 3, Aberdeen Marina Tower
8 Shum Wan Road, Aberdeen, Hong Kong
Tel: +852 2555-2805
STARSHIPYACHTS.COM
info@starshipyachts.com