



Princess S65

65ft | Princess | 2018

★ STARSHIP YACHTS

24 Po Chong Wan, Shum Wan Road, Aberdeen,
Hong Kong
Tel: +852 2555-2805
STARSHIPYACHTS.COM
info@starshipyachts.com



Princess S65

3 staterooms | 2018 | 8 Guests

Cruising Speed	28 kn
Max Speed	36 kn
Engines	MTU V12 1400 HP
Length Overall	19.9m (65'6")
Beam	5.08m (16'6")
Draft	1.45m (4'76")
Cabins	4+1 (crew)

For Sale: USD \$2,000,000

Princess S65

Main Deck - Saloon



Princess S65

Main Deck - Galley & TV



Princess S65

Main Deck - Helm Station & Forward Saloon



Princess S65

Lower Deck - Master Cabin



Princess S65

Lower Deck - Master Cabin



Princess S65

Lower Deck - VIP Cabin



Princess S65

Lower Deck - Forward Guest Cabin Head & Port Side Cabin



Princess S65

Lower Deck - Guest Cabin & Day Head



Princess S65

Engine Room, Garage & Hydraulic Platform



TECHNINICAL SPECIFICATIONS

Princess S65

Length Overall	19.9m (65.6 ft)
Max Beam	5.08m (16.6 ft)
Draft	1.45m (4.76 ft)
Engines	MAN V12 1400 HP
Engine Hours	784
Generator	ONAN 19.5kW/50 Hz
Generator Hours	2500
Fuel Capacity	1083.11 Gal
Fresh Water Capacity	290.59 Gal
Maximum Speed	36 kn
Cruise Speed	28 kn
No max. passengers	16
No of Cabins	4 + 1 (crew)
Year Built	2018

Outline specification believed to be correct but not to be taken contractually

24 Po Chong Wan, Shum Wan Road, Aberdeen, Hong Kong

Tel: +852 2555-2805

STARSHIPYACHTS.COM

info@starshipyachts.com

LAYOUT | Princess S65

Sportbridge

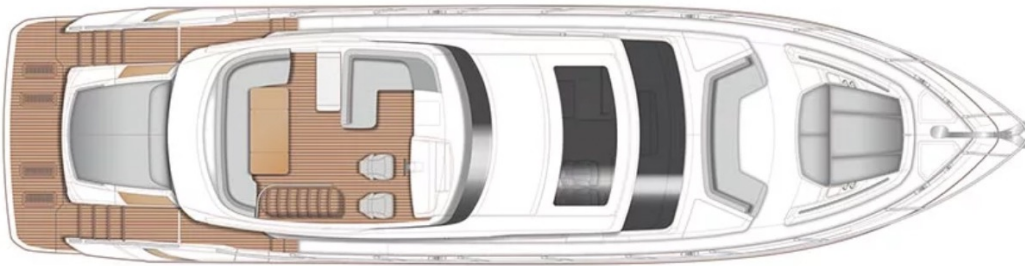

Main Deck

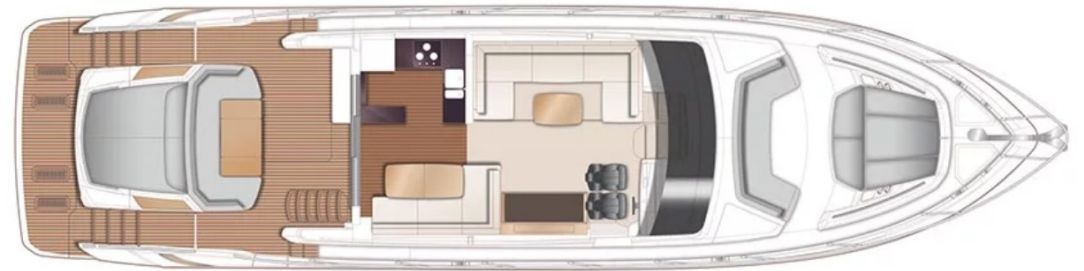

Lower Deck

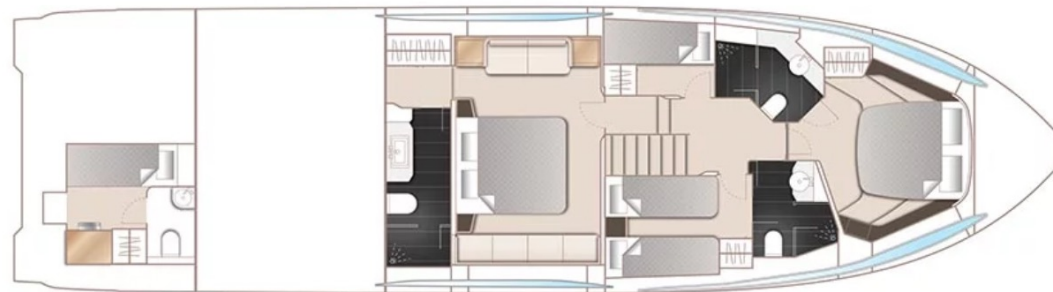

Outline specification believed to be correct but not to be taken contractually

24 Po Chong Wan, Shum Wan Road, Aberdeen, Hong Kong
Tel: +852 2555-2805
STARSHIPYACHTS.COM
info@starshipyachts.com

ACCESSORIES | Princess S65

Stabilization:

Seakeeper Gyro Stabiliser (NG9)

Interior furniture:

Walnut interior wood Satin finish (galley, aft saloon & helm floor are walnut)

Layout:

Crew cabin fit out (single berth with separate WC and shower)

Starboard cabin to have double berth conversion sliding mechanism on inboard berth

Saloon coffee table top in Carrera White

Galley:

Galley workshops are Porcelain White solid surface

Bathrooms:

Master stateroom bathroom countertops and floors are Carrera White (gloss finish).

Forward & Starboard bathroom countertops are Carrara White (gloss finish) with Koko White (satin finish) floors

Deck Hardware:

Electro hydraulic transom platform with 500KG SWL capacity

Teak laid side decks and foredeck

Electric stern rope handling winches (2)

Electro-hydraulic telescopic passarelle (3.5m) with automatic handrails

Electrically operated sliding roof over forward saloon area

Electrically operated sun awning to aft end of cockpit

Stainless steel anchor in place of standard

Additional 20m of 10mm anchor chain to give a total of 80m

Generator & Electrical:

ONAN 19.5kW/50Hz generator in place of standard

Continental 220v/240v sockets

Icemaker fitted in Sportbridge bar

Lava Brick BBQ

Underwater transom lights (4 LUMISHORE SMX52 white)

Heated towel rail in bathroom (3 pcs)

Stern docking lights fitted to aft end of sportbridge

Outline specification believed to be correct but not to be taken contractually

24 Po Chong Wan, Shum Wan Road, Aberdeen, Hong Kong

Tel: +852 2555-2805

STARSHIPYACHTS.COM

info@starshipyachts.com

ACCESSORIES | Princess S65

Audio visual & Communications:

Deck Saloon – 49” HD LED TV on power lift mechanism with Harman Kardon 2.1 Blu-Ray system with Bluetooth connectivity and KEF speakers

Owners stateroom - 40” HD LED TV with Harman Kardon 2.1 Blu-Ray system (with Bluetooth connectivity)

Forward Guest Cabin – 32” LED TV with Fusion UD650 Radio/iPod/MP3 Player

Sportbridge - Fusion MS-UD755 Radio/iPod/MP3 Player with waterproof speakers

Navigation:

Raymarine es128 Radar/Chartplotter with GPS & 12.1” brilliant colour multifunction displays with 4kw SHD 48” digital colour open array scanner with 2 displays at lower helm and 2 displays at upper helm

Raymarine p70Rs autopilot with rate gyro and i70s colour multifunction instruments

4 x Raymarine e165 15.4” brilliant colour multifunction displays (2 at each helm position)

AIS Class B Transponder interfaced with chartplotter with 8ft aerial

European Version plotter

International VHF

Airconditioning:

Airconditioning/heating reverse cycle (88.000 BTU)

Aft cabin airconditioning

Heating/Demist:

Windscreen demist system using warm air heater powered from calorifier

Mosquito Screens:

Mosquito screens for opening portlights

Exterior Upholstery/Canvas/Covers:

Bimini Top – Charcoal Grey sunbrella Canvas

Bimini Top with LED overhead lighting

Cockpit and Sportbridge covers in canvas/acrylic material

Outline specification believed to be correct but not to be taken contractually

24 Po Chong Wan, Shum Wan Road, Aberdeen, Hong Kong

Tel: +852 2555-2805

STARSHIPYACHTS.COM

info@starshipyachts.com