

JUST LIKE  
HOME.



  
FERRETTIYACHTS

COLLECTION 2021-22  
产品系列

JUST LIKE  
HOME.





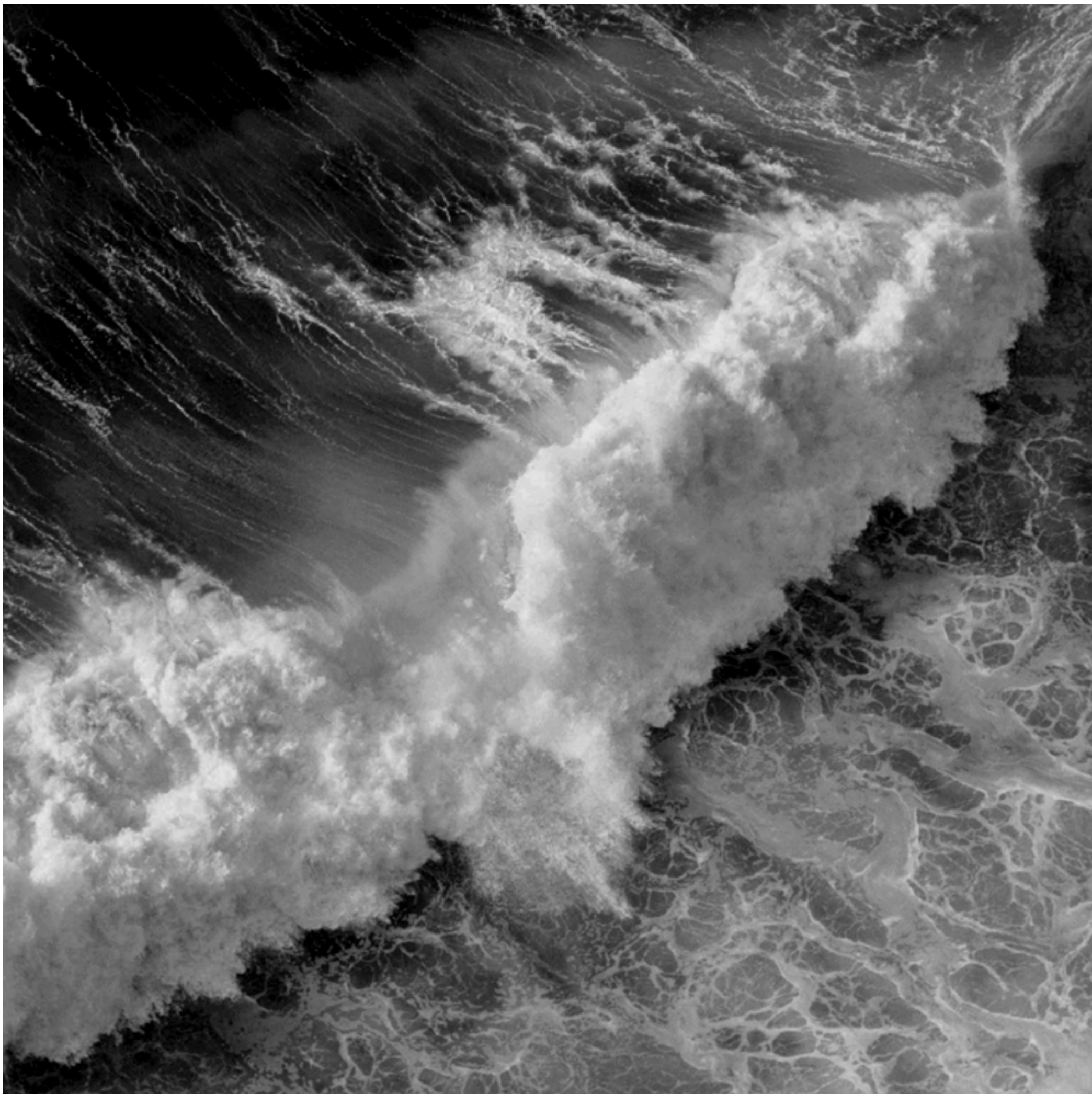

JUST LIKE HOME FERRETTI YACHTS' CRAFT ARE DEDICATED TO THOSE WHO LOVE TRAVELLING THE WAYS OF THE SEA, WHERE THE STORIES OF THOSE WHO CROSS THEM ARE CARRIED ON THE WAVES, AND MINDS OPEN UP TO NEW HORIZONS. TO THOSE WHO DREAM OF WAKING UP IN THE MORNING TO GAZE UPON THE TWINKLING LIGHTS OF DAWN FROM THE SOFT SHEETS OF THEIR OWN BED, WHEN THE SUN RISES FROM THE SEA IN ALL ITS SPLENDOUR. TO THOSE WHO ENJOY THE FRESHNESS OF DIVING INTO THE CRYSTALLINE WATERS OF THE OCEAN, TO THEN INDULGE IN A BATH OF PURE WELL-BEING. TO THOSE WHO WANT TO FEEL THE WARMTH OF THE LAST RAYS OF THE SUN ON THEIR SKIN, WHILE SAVOURING A GLASS OF WINE, IN FRONT OF A VIEW THAT WARMS THE HEART. TO THOSE WHO DECIDE TO SET OFF WITHOUT EVER LEAVING HOME, FERRETTI YACHTS DEDICATES AN ENTIRE FLEET, WHOSE PERFORMANCE, COMFORT AND STYLE GUARANTEE THE DOMESTIC WARMTH THAT ONLY A PLACE WE FEEL TRULY AT HOME CAN GIVE US. EACH SPACE IS EXPERTLY TRANSFORMED INTO A DESIGN SPACE, THANKS TO A SKILFUL SYNERGY INCORPORATING FUNCTIONALITY AND STYLE. AN ELEGANT INTERPLAY OF LINES, MATERIALS AND TECHNOLOGICAL INNOVATION BRINGS A DISTINCTIVE IDENTITY TO THE BRAND, MAKING IT UNIQUE AND ADMIRABLE IN EVERY PORT ON THE SEVEN SEAS. OVER FIFTY YEARS OF EXPERIENCE IN SAILING BOATING COMFORT MEAN THAT FERRETTI YACHTS GUESTS FEEL LIKE PEARLS NESTLED AGAINST A GOLDEN BACKDROP, WRAPPED IN A TOTAL WELL-BEING THAT BEGINS IN THE BODY, REACHES THE MIND, AND ENCHANTS THE SOUL. A JOURNEY ON THE SEA BECOMES AN INNER JOURNEY, RICH IN INCOMPARABLE, BRAND-NEW EXPERIENCES. THIS REFINEMENT AND ATTENTION TO DETAIL INSPIRE FERRETTI YACHTS TO OFFER ALL THE ENJOYMENT OF PLEASURE BOATING, IN A SETTING IN WHICH TO FEEL AT HOME; FREE, SAFE AND PAMPERED. A NEW WAY TO TRAVEL AND EXPERIENCE THE WATER EMERGES, AS WELL AS A NEW PERSONAL AND AUTHENTIC SPACE. FERRETTI YACHTS' CRAFT ARE DEDICATED TO ALL THOSE WHO SET SAIL IN SEARCH OF NEW EXPERIENCES, BUT WHO DOCK IN THE SAFE HARBOUR OF THEIR OWN HOME. **FERRETTI YACHTS, A NEW APPROACH TO LIFE AT SEA.**

法拉帝游艇，为热爱跨越山海的人而生，他们的故事能乘风破浪，所见视野令人心弛神往；为梦想在海上晨曦中醒来的人而生，他们从软被轻床间醒来，便可饱览晨光；为面朝如晶碧海一跃而入的人而生，他们享浴于海水的清澈和纯美之间；为任由落日余晖抚过肌肤的人而生，他们享一杯醇酒，伴面前美景沁入心田；为不舍离家的启程者而生，法拉帝游艇用舒适和格调营造家的温暖，让他们游历四海时携家同行。得益于功能与格调的巧妙融合，艇上每一处空间都镌满艺术。线条、材料和科技创新在这里交相辉映，赋予品牌与众不同的鲜明个性，无论泊于全球任何一个港口，都能艳压群芳。船厂五十多年关注航海舒适感受的丰富经验，意味着法拉帝游艇的客户仿若枕靠绚烂而居的珍珠，被幸福包裹着。这种幸福始于肢体，触及心灵，摄入魂魄。海上之旅成为心灵之旅，无与伦比的全新体验无处不在。细节备至，精致如斯，激发着法拉帝游艇为休闲船舶填满每一丝欢愉，在此氛围内营造居家般的感受：自由、安全、备受宠爱。一种全新的亲水旅行方式跃出海面，一个私密而纯粹的空间应运而生。法拉帝游艇专为那些启航寻找别样体验的人士而造，同时又让他们时刻感觉停靠于安全的港湾之中，温馨如家，从未远离。 **法拉帝游艇，始终引领海洋生活新风尚。**





FERRETTI YACHTS 720































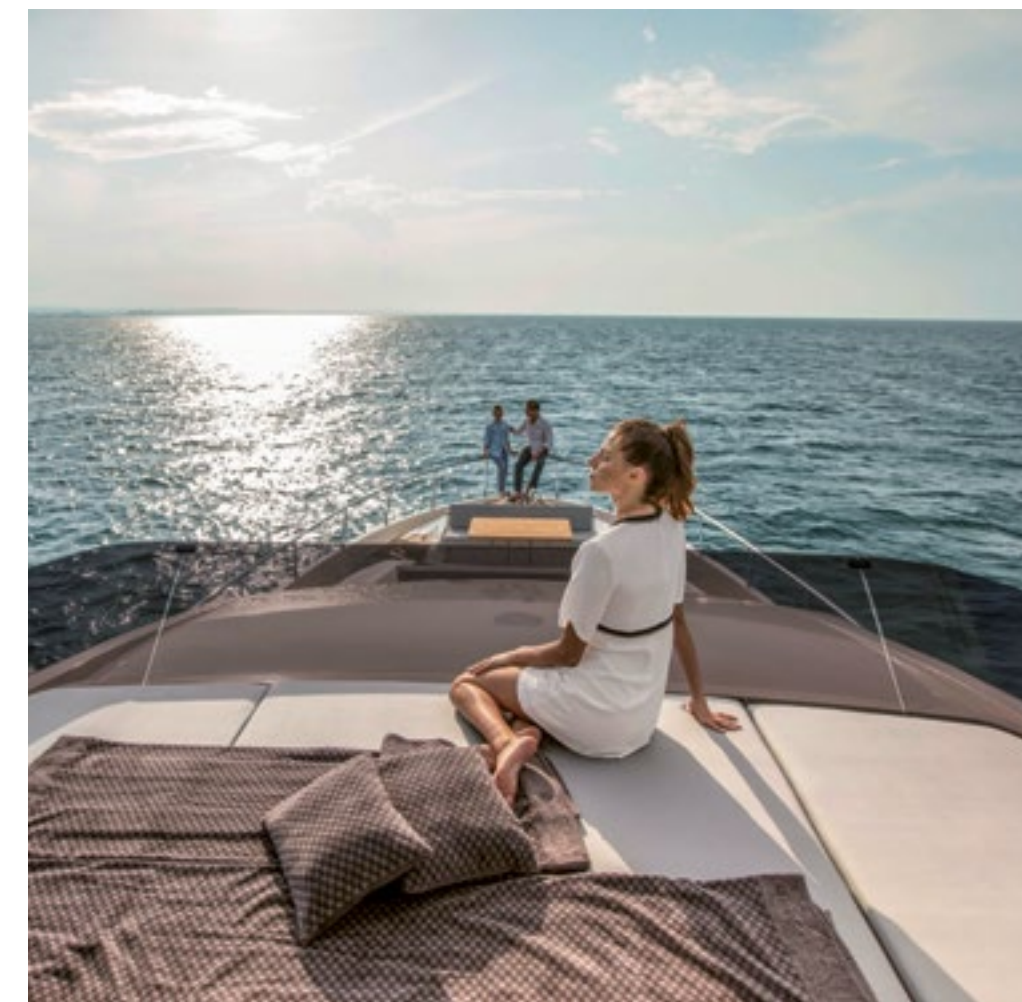







INTERIORS  
内饰

































# FERRETTI YACHTS 720



STANDARD VERSION 标准版本



HARD TOP VERSION 硬顶版本

## ENGINES AND SPEED

STD	OPT
2 x MAN V8 1200 Power 1200 mhp/882 kW at 2300 rpm	2 x MAN V12 1400 Power 1400 mhp/1029 kW at 2300 rpm
Maximum speed	Maximum speed
<b>28 knots</b>	<b>32 knots</b>
Cruising speed	Cruising speed
<b>24 knots</b>	<b>28 knots</b>

## MAIN SIZES

LOA = Overall Length standard ISO 8666	<b>22,3 m - 73 ft. 3 in.</b>
LH = Hull length standard ISO 8666	<b>21,0 m - 69 ft. 0 in.</b>
Maximum beam	<b>5,6 m - 18 ft. 4 in.</b>

## TECHNICAL DATA

Displacement unladen	<b>46 t - 101413 lbs.</b>
Fuel tank capacity	<b>4600 l - 1215 US Gals.</b>
Design category	<b>A</b>
Displacement laden	<b>54 t - 118088 lbs.</b>
Water tanks capacity	<b>1000 l - 264 US Gals.</b>
Certification modules	<b>B + F + Aa (Sound Emission) RINA S.p.A.</b>
Depth under propellers (boat fully laden)	<b>1,8 m - 5 ft. 9 in.</b>
Maximum number of people on board	<b>18</b>

The Technical data, performances, designs and graphic reproductions are purely indicative, are not contractual, shall not constitute in any circumstances whatsoever any contractual offer by the shipyard and refer to European standard models of motor yachts built by the shipyard. The only valid technical reference or description is the specific parameters of each motor yacht cited only on purchase of the same. Therefore the only indications binding on the seller are contained solely in the sale agreement and in the relevant specific manual.

## 发动机和速度

标配	选配
标配 2 X MAN V8 1200 发动机 每台额定功率1200 马力 / 882 千瓦 (转速达2300转/分钟时)	2 X MAN V12 1400 发动机 每台额定功率1400 马力 / 1029 千瓦 (转速达2300转/分钟时)
最高速度	最高速度
28 节	32 节
巡航速度	巡航速度
24 节	28 节

## 主要尺寸

LOA=全长 (ISO 8666)	22.3 米 - 73 英尺 3 英寸
LH = 船体长 (ISO 8666)	21.0 米 - 69 英尺 0 英寸
型宽	5.6 米 - 18 英尺 4 英寸

## 技术数据

空载排水量 (即船重)	46 吨 - 101413 磅
油箱容量	4600 升 - 1215 美加仑
设计等级	A
满载排水量	54 吨 - 118088 磅
水箱容量	1000 升 - 264 美加仑
证书类型	B + F + Aa (噪音排放) RINA船级社
满载吃水深度	1.8 米 - 5 英尺 9 英寸
限载人数	18

## APAC



Roll Bar version  
雷达架版本



Hard Top version  
硬顶版本

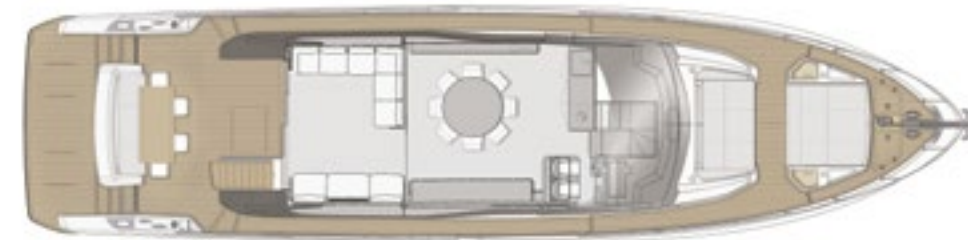

3 cabins + 3 bathrooms  
3 客舱 + 3 卫浴

## EMEA



Roll Bar version  
雷达架版本



Hard Top version  
硬顶版本



4 cabins + 3 bathrooms  
4 客舱 + 3 卫浴





## *Leading the Future* 引领未来

### *Creating Greatness*

*This is our commitment as a luxury yachting group. This is the spirit that drives us, individually and collectively. This is the value we bring for our employees, our brands, our clients and society as a whole.*

### *Empowering Expertise*

*We continually spur each of our brands to go further. We leverage their special know-how, artisanal accomplishment and technological expertise to stay at the cutting edge of the nautical world.*

### *Striving for Innovation*

*Ferretti Group delivers excellence through constant innovation and pioneering technology. This is how we achieve formidable performance and safety at sea, offering clients authentic experiences to satisfy their desires for affirmation and self-expression.*

### *Creating Value*

*We focus our energy and resources on supporting our brands in their long-term development, further boosting their ability to create value. This has earned us extraordinary success over the years, helping the group become a pre-eminent player in today's yachting sector.*

### *Going Global*

*Ferretti Group always endeavours to be close to the market and to our customers, doing whatever it takes to deliver exceptional performance. We have built up an agile, resourceful international dealer network, supported by high-end marketing initiatives to enhance our brands' worldwide visibility and profile.*

### *Softening our impact on the environment*

*Ever aware of the need to consider the environmental and social side-effects of our products and processes, Ferretti Group publishes a Sustainability Report every year. This document maps the main impacts of our activities and outlines the initiatives in place towards more sustainable development.*

### **缔造伟业**

作为一家豪华游艇制造集团，这是我们的使命。正是这种精神驱使着我们所有个人与集体，带给员工、品牌、客户与社会整体以最大价值。

### **赋能专业**

我们持续激励旗下所有品牌大步向前，充分利用它们的独门绝技、手艺成就和技术专长，始终屹立于游艇业之巅。

### **追求创新**

通过所掌握的前沿科技与持续创新，法拉帝集团铸就卓越。凭借令人信赖的性能与海上安全，为客户提供真实的体验，满足他们获得肯定与自我表达的渴望。

### **营造价值**

我们集中精力与资源支持旗下各品牌的长期发展，进一步提升它们创造价值的能力。多年以来，此举帮助整个集团取得非凡的成功，成为当今游艇业的佼佼者。

### **迈向全球**

法拉帝集团始终在努力接近目标市场与客户，竭尽所能提供卓越表现。我们建立了一个资源丰富而灵活的全球经销商网络，辅以高端市场举措，不断提高我们在全球范围内的品牌形象与知名度。

### **呵护环境**

考虑到我们的产品在使用及制造环节给环境和社会所带来的一定副作用，法拉帝集团每年都会发布一份可持续发展报告。这份报告具体阐述了我们的业务对环境的主要影响，并概述了为实现更可持续发展而采取的环保举措。

ferrettigroup.com



PERSHING

Itama

Riva

CRN

CUSTOM LINE



## LEGAL NOTICE

1. This brochure does not constitute an offer by the shipyard to any person under any circumstances whatsoever, nor may it be incorporated into any contract.
2. All the information in this brochure, including without limitation all technical and performance data, illustrations and drawings, has no contractual effect. That information refers to European standard models of motor yachts built by the shipyard and is accurate at the brochure's date of issue. The only valid technical description or reference content for an individual motor yacht is the exact specification stated at the time of purchase. Therefore, the only information that is binding on the seller is that contained in the sale agreement and associated manual. This brochure is based on information available at the date of issue. Notwithstanding Ferretti Group's best efforts to ensure accuracy, the information in this brochure may not cover all details or subsequent changes, nor does it claim to accurately foresee or detail all possible scenarios. Displays, photos, diagrams, designs or examples in this brochure are reproduced solely and exclusively to highlight the information contained. Each yacht is different, so the shipyard declines any and all liability for any use thereof on the basis of the information in this brochure.
3. The brochure and its contents must not be copied or reproduced in their entirety or in part.
4. Sale of this brochure is not permitted.

## 法律公告

1. 本产品画册在任何情况下不得作为船厂提供任何人的报价或作为任何合同的一部分。
2. 本产品画册包含的任何信息不具法律效力,包括但不限于所有技术参数、性能、插图及图纸。这些信息适用于船厂建造的所有欧洲标准动力游艇型号,并由船厂在产品画册完成前得到更新。唯一有效的技术参考或描述为每艘游艇在被购买时所提供的特定参数。因此,唯一对卖方具约束力的内容仅存在于销售协议和相关特定手册中。本产品画册的内容是基于完稿前所能获得的相关信息。尽管我们努力确保准确性,本产品画册包含的内容可能未包括所有细节、后续改变,以及未准确预见或报告的所有可能情况。本产品画册所包含的展示、照片、方案、设计或样例,仅为强调所含信息而印制。由于每艘游艇的不同特性,船厂对使用本产品画册所包含的信息而发生的任何后果不承担任何法律责任。
3. 本产品画册及其整体或部分内容均不得复制或转载。
4. 本产品画册不得对外销售。





**Concept and art direction / 概念和艺术指导**

Lorenzo Marini Group - Menabò Group  
Undesign

**Photos / 摄影**

Alberto Cocchi  
James Raycroft  
Katerina Kalzhanova  
Leonardo Andreoni  
Maurizio Paradisi  
Francesca Cocchio  
Lorusso Images Studio

**Technical drawings / 技术制图**

Ferretti Group Engineering  
Arch. Filippo Salvetti  
Zuccon International Project  
IDEAEITALIA ARCHITETTI

**Naval & technical design / 船舶和技术设计**

Ferrettigroup Engineering Department

**Exterior design / 外观设计**

Ferretti Group in collaborazione con Arch. Filippo Salvetti.  
Ferretti Group in collaborazione con Zuccon International Project

**Interior design / 室内设计**

Ferretti Group in collaborazione con IDEAEITALIA ARCHITETTI

**Printing / 印刷**

Tipostampa

**Styling / 画册风格**

Elisa Rampi  
LDI Design  
Luigi Gaballo  
Benedetta Baruffi

**Thanks to / 致谢**

Abbondio  
Adriani&Rossi  
Albertalli  
Alberta Ferretti  
Allison  
Arte e cuoio  
Artemide  
Arte Pura  
Atelier Franchising  
Bitossi Ceramiche  
Borsalino  
Bosa  
Campidelli  
Carlo Moretti  
Carrara Home Design  
Cerdelli Sarnico  
Christoffle  
Cipriani Food  
Colombo  
[Confort Zone]  
Danese Milano  
Davines  
De Vecchi  
discover-beauty.com  
D'O

Driade  
Egizia  
Elvang  
Etro Home  
Fendi Casa  
Fferrone  
Flos  
Fontana Arte  
Foodies per Stazione di Salice  
Foscarini  
Francesco Faravelli  
Gallotti&Radice  
Gardeco  
Gavina Via.gg.io  
Gentili Mosconi Home  
Ginori 1735  
Giobagnara  
Hermès  
iittala  
Ivano Redaelli  
Ivv  
Kalin  
KN Industrie  
Kiehl's  
Laboratorio Olfattivo

Lanificio Colombo  
Larusmiani S.p.a.  
La tavola  
Le Manine  
Lene Bjerre  
Les Ottomans  
Linit  
Loro Piana  
Louis Roederer  
Luce in  
Luceplan  
Marzotto Group  
Mauro Bolognesi  
Mepra  
Molteni Home  
Monom  
Mulattieri Creations La Spezia  
Nahoor  
Nason&Moretti  
Nuxe  
Oltrefrontiera  
Oluce  
Petra di Luna  
Pinetti  
Poltrona Frau

Profumeria Arrighi Forli  
Rabarama  
Recarlo  
Rexite  
Richard Ginori  
Riviere  
Salvatori Marmi  
Salviati  
Sandi & Martinis  
Scandola Marmi  
Schönhuber Franchi  
Semeraro  
Sisley Cosmetics Paris  
Skultuna  
Smania  
Society  
Somma  
The Bridge  
Tivoli Audio  
Tom Dixon  
Toscanini  
Venini  
Vesoi  
Vontree  
Zanaboni

